

TECHNICAL SPECIFICATIONS | 407 GOLD SFC 2955 WB, 4.65 Ton

TYPE	Truck Chassis with Cab & Load Body
POWERTRAIN	
Engine Type	4SPCR BS6
Displacement/Cubic Capacity	2956cc
Max. Power Output (in kW)	73.5 kW (100PS) @2800 r/min
Max. Torque	300 Nm @ 1200 -2200 r/min
Bore x Stroke	97 mm x 100 mm
Clutch	Single plate dry friction type- 280 mm dia
Transmission	G400, 5 Speed, Manual Synchronesh Gearbox (5F, 1R), PTOP
FUEL SYSTEM	
Fuel Injection System	M/s Delphi (suitable upto 2000 bar)
Fuel Tank Capacity	60 Liter
ELECTRICALS	
Battery	12V, 75 ah capacity
Alternator	120 amps
PERFORMANCE	
Max. Gradeability (1st Gear)	40 %+
STEERING	
Steering System	Power Steering
FRAME	
Frame	Ladder type frame with riveted/bolted cross members (5 no)
Long member size	180 x 55 x 5
BRAKES	
Service Brake	Vacuum assisted; Hydraulic two leading slide shoe; Auto Slack Adjuster
Parking Brake	Transmission mounted parking drum brake
SUSPENSION & TYRES	
Front Suspension	Parabolic spring with rubber bush, 2 no Hydraulic Double acting Shock Absorbers
Rear Suspension	Semi elliptical leaf spring, 2 no Hydraulic Double acting Shock Absorbers
No. of tyres	Front 2,Rear 2 , Spare 1
Front	7.00 R 16LT, 12PR
Rear	7.00 R 16LT, 12PR

WEIGHT	CAB	CLB	HD
Front Axle Weight -FAW (in kg)	1480	1490	1500
Rear Axle Weight -RAW (in kg)	800	995	1050
Kerb Weight (in kg)	2280	2485	2550
Gross vehicle weight (in kg)	4650	4650	4650
OVERALL DIMENSIONS			
Wheel base (in mm)	2955	2955	2955
Overall Length (in mm)	4687	4850	4850
Overall Height (in mm)	2260	2260	2270
Overall Width (in mm)	1905	2100	2100
LOAD BODY DIMENSIONS			
Load body Length (in mm)	NA	2532	2532
Load body Width (in mm)	NA	2000	1965
Load body Height (in mm)	NA	325	1835
Minimum Turning Dia (in metres)	11.9		
Minimum Ground Clearance (in mm)	209	209	209
Seating Capacity	Driver + 2	Driver + 2	Driver + 2
Warranty	3 years or 300000 km, Whichever is earlier*		

For details, please refer to operator's service book

TATA MOTORS
SAMARTH

Dealer Stamp



TATA MOTORS

For more information, please visit our website: www.light-trucks.tatamotors.com
You can also contact our Sales Office: Tata Motors Limited, 4th Floor, Ahura Centre, 82, Mahakali Caves Road, MIDC, Andheri (East), Mumbai - 400 093 or call toll-free no. 1800 209 7979.

Terms & Conditions apply as per the policy of ITGI. Insurance available on light, intermediate & heavy commercial vehicles.
CAUTION: Accessories shown in the picture or elsewhere do not constitute standard fitment. The specifications are merely indicative. Due to continuous product improvements, these specifications are liable to change without notice.

TATA MOTORS
Connecting Aspirations



Presenting The Gold Standard of LCV Pick up in BS6

TATA 407 GOLD SFC



H2LS
BRAKES



DRIVER'S
SAFETY



POWER
STEERING



FUEL-EFFICIENT
ENGINE



3-YEAR/3 LAKH KM*
WARRANTY



IN-BUILT
MUSIC SYSTEM



MOBILE
CHARGING SOCKET



HEAT-RESISTANT
FEATURES

TATA MOTORS NEW BS6 ILCV RANGE

EXPERIENCE THE



EXPERIENCE THE
POWER OF CHANGE

BS6 THE POWER OF 6



1
POWER OF
GREATER PROFITS



4
POWER OF GREATER
CONVENIENCE &
CONNECTIVITY



2
POWER OF ENHANCED
PERFORMANCE



5
POWER OF
GREATER VALUE

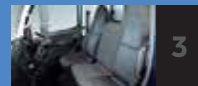

3
POWER OF INCREASED
DRIVING COMFORT



6
POWER OF IMPROVED
SAFETY AND SECURITY



SAFETY ENHANCED with
more solid built quality
on SFC Cabin



Serrated Coupling flange
propeller shaft for better
Reliability, Maintenance



Power steering with reduced
effort & new steering wheel

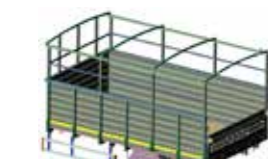

Light Weight Loadbody
with increased strength



High Quality Music System
with Blaupunkt Speakers &
High Speed USB Mobile Charger



Improved Ergonomic pedal
positions to reduce fatigue



Lower NVH with improved engine mount
and Parabolic suspension with rubber Bush



Banjo Type Rear Axle
More Load carrying capacity,
less prone to leakage



Long member thickness
is increased to 5mm



Gradability
Improvement (~40%+)



Lower Gear Shift Effort
with optimized
Gear Shift travel



H2LS Brakes for better
Efficiency



Reduced clutch effort
by 40%



New Multi-Function
Ergonomic Instrument Cluster
With Gear Shift Advisor



Seat adjustment in
XZ Direction & Improved heat
resistant melba fabric seats

The 34 year long legacy of India's favorite 407 is set to continue and achieve greater heights as the 407 Pickup is back in an all new and Improved avatar! Today, the TATA 407 GOLD is not just another Pickup, but an emotion and an answered prayer to Thousands of Proud Owners, seeking profitable solutions to grow their business. Rightly named as "The Non Stop Profit Machine", this vehicle now offers its owners the 6 six powers of profits, performance, Driving Comfort, Convenience & Connectivity, Value as well as Safety & Security, thus providing owners a powerful tool to grow their business to its fullest potential. Tata Motors is the ONLY manufacturer in India selling the SFC Styled Cabins with the 'Unique NOSE' for highest levels of safety.



Upgraded BS6 Features
that Leads to

➤ Highest Reliability

➤ Best Drivability

➤ Non Stop Profits

UTILITIES THAT MAKE 407 GOLD THE BEST CHOICE



Service Interval of 40 000 km;
Warranty 3-year or 3 lakh km*



Extra Low:
Lowest Loading Platform

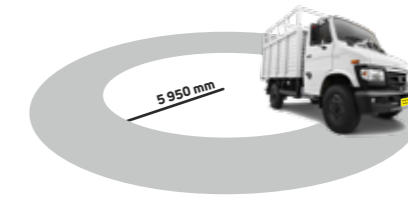

Rule the Road:
Shortest Turning Circle Radius



Less is More:
India's Shortest Pickup

The DNA of BS4 Engine is carried to the 4SP CR BS6 Engine so that the same reliability & Mileage Superiority is achieved



Improved Drivability because of improved Low end torque and Flat Torque Range-Better Mileage

Extra Large:
Largest Loading Area



Extra Muscle:
India's highest payload pick up : 2 T



ALL-SEASON MANY APPLICATIONS



Fruits & Vegetables



Gas Cylinders



Cold Drinks



Milk Cans



FMCG



Tent House



Dairy Products



E-commerce

*Images used are representative purposes only
**Technical specs are subjected to be changed & are applicable under standard test conditions

*Images used are representative purposes only
**Technical specs are subjected to be changed & are applicable under standard test conditions